



Water heating tank installation instructions

BOT-30 RV

BOT-40 RV



Distributor: Skamet OÜ
Savi 9, Pärnu, Estonia 80040
Tel: +372 4401 000
www.skamet.ee
info@skamet.ee

Manufacturer: Arkam
Darius and Girėno str. 173, Vilnius
Tel. +370 606 83851
www.arkam.lt
arkam01@gmail.com

Water heating tank installation instructions

The water heating tank is intended for the preparation of warm water in the sauna. Produced in 30, 40 liters volume. Once it is mounted from above on the smoke exhaust pipe of the stove, it utilizes the heat of the outgoing smoke. The tank is made of stainless steel and is conductive to heat, therefore heats up quickly. If the stove is turned on for a long time, the water may boil. Boiling can be avoided by draining the heated water and replacing it with cold water. There should always be water in the tank.

Installation progress

The water heating tank is installed on the top of the stove, so you need to remove the plug (115 mm) from the top smoke outlet of the stove and use it to close the opening on the back of the stove. Turn the plug retainer spring until it locks firmly, covering the opening. Make sure the plug is securely attached. Install the water heating tank on the stove so that the filling hole (with the wooden handle) is at the top, and the insert passing through the tank is firmly seated on the flue pipe of the stove. When installing other parts of the chimney, keep the position of the water tank stable.

Distributor: Skamet OÜ
Savi 9, Pärnu, Estonia 80040
Tel: +372 4401 000
www.skamet.ee
info@skamet.ee

Manufacturer: Arkam
Darius and Girėno str. 173, Vilnius
Tel. +370 606 83851
www.arkam.lt
arkam01@gmail.com

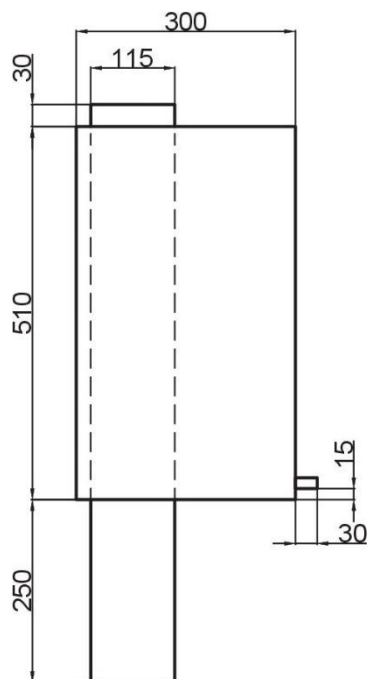

BOT-30 RV

Vandens bakelis 30 l

Water tank 30 l

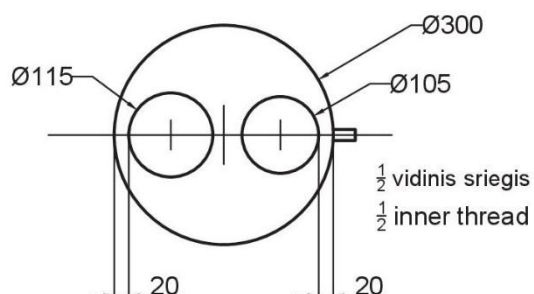

BOT-40 RV

Vandens bakelis 40 l

Water tank 40 l

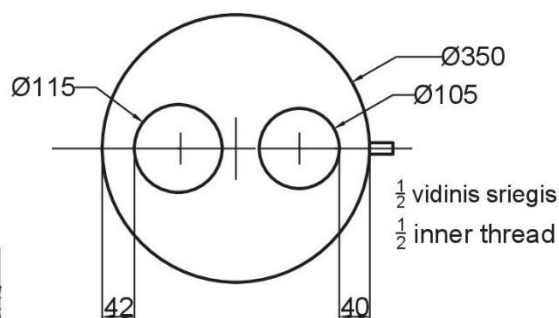
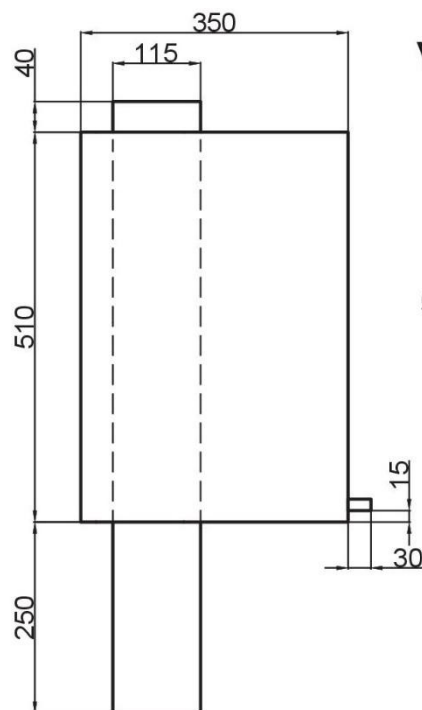

Distributor: Skamet OÜ
Savi 9, Pärnu, Estonia 80040
Tel: +372 4401 000
www.skamet.ee
info@skamet.ee

Manufacturer: Arkam
Darius and Girėno str. 173, Vilnius
Tel. +370 606 83851
www.arkam.lt
arkam01@gmail.com

Usage requirements

When using a water heating tank, the following points must be considered:

- use high-quality water, because a high iron content causes corrosion of the tank material, and limewater destroys the shine of the material. Good quality lake water is suitable for use in a water heater and will not damage the tank material if the heater is thoroughly cleaned periodically. Mechanical cleaning. If rust spots appear on the water heating tank due to some external reason, they can be removed with wet sandpaper with a grit of 400 grit or more. After grinding, the heater must be thoroughly cleaned.

- during heating, fill the water tank with as much water as possible.

- when you do not use the water heating tank for a long time, it is advisable to clean it, because the quality of the water left for a long time may deteriorate. Use water and a soft cloth to clean the tank. Do not use strong detergents for cleaning!

- keep the water in the tank from freezing. When the temperature drops below 0°C, water freezes, expands and can damage the tank and faucet. Drain the water from the water tap and leave the tap open. To extend the life of the water heating tank, remove the small amount of water left at the bottom of the tank with an absorbent sponge or cloth, for example.

- The upper edge of the water tank is rolled and not welded. It is made specifically to keep the tank from deforming (in case the hot water in the tank starts to boil).

